

Proposed Goals and Actions

Goals and actions were developed from community comments gathered in the previous phases of this planning process

Please review and leave comments on the board using the materials provided at this station.





***Building Tomorrow, Honoring Yesterday
Preserving History While Developing Housing***

Lift up to view proposed initiatives that North Avondale and neighborhood partners can take on to address their desire to preserve history and create homes for current and future residents.

Historic overlay district (active initiative)

Record and celebrate neighborhood history

- Research key community leaders and families
- Establish historical sites, and monuments
- Fund and promote public artwork celebrating local history



Assist with property maintenance

- Home improvement assistance (Financial assistance programs)
- Absentee and existing landlord engagement
- Homeowner engagement (How can the community help?)

Implement community enhancement initiatives

- Become active partners in development
- Build or collaborate more closely with a CDC
- Inventory and address problem property
- Community clean ups (connected block captains – empowered neighborhood residents)





Securing Tomorrow, Today
Collaborative Solutions for Enhancing Public Safety

The community comments regarding neighborhood safety are directly addressed in the *Avondale Quality of Life Plan*. Working collaboratively with Avondale to support their initiatives will ensure a shared solution towards this shared goal.

Increase after-school places and programs

(QOL) Avondale's youth and families are supported in and out of school by an intergenerational network of Avondale residents and stakeholders. pg. 32

Improved relationship with Police

(QOL) Avondale is a model for police community relations and is subsequently changing the perception of Avondale as an unsafe community for residents and those living outside of Avondale. pg. 34



Support leaders working to create stable places

(QOL) Avondale residents are engaged and actively participating in neighborhood safety. pg. 33

Support residents in need of mental health services.

(QOL) Mental Health organizations placing individuals receiving mental health services partner with landlords and law enforcement to ensure services are in place and provided for each of these residents. No more dumping of residents in need of mental health services. pg. 32





***Green Paths that Connect the Community
Creating Ties with Improved Parks and Greenspace***

Parks and greenspace is a strength of North Avondale. This asset can be enhanced to deepen community pride and create a safe and enjoyable place for the neighborhood to gather.

Connecting parks

- Pathways and improved signage linking parks and greenspace
- Enhanced gateways
- Improved street and park visibility

Increasing tree canopy

- Identify high priority areas
- Assist homeowners with private property planting
- Collaborate with City partners to increase tree canopy



Refer to Parks and Greenspace Concepts

GREENSPACE OPPORTUNITIES
DIAGRAM

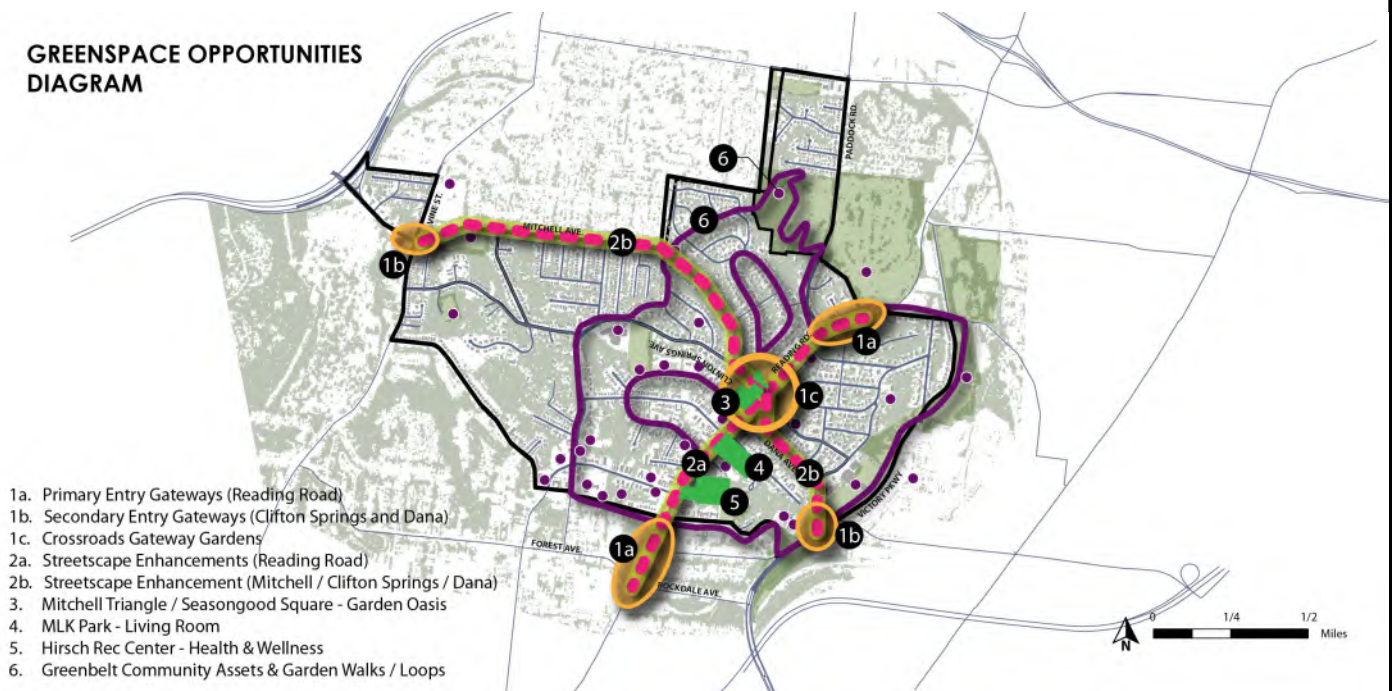



Foster an Engaged Community

The neighborhood is full of people who want to make North Avondale the best place to live. Focusing all these voices, attention and effort on strategic shared initiatives can lead to wider-community support and a greater likelihood of planning success.



Advance a Diverse and Inclusive Neighborhood

The neighborhood's diversity is celebrated, with a strong desire to maintain an inclusive atmosphere where all types of people feel welcome. Community comments placed an emphasis on maintaining economic and cultural diversity, supporting affordable housing initiatives, and fostering a sense of inclusivity and community cohesion.

Improve schools and education centers

- After-school programs
- Building intergenerational relationships
- Enhancing social infrastructure (ex. libraries, parks, worship spaces, restaurants and cafés)

Jobs and career training

- Neighborhood job creation

Support black owned and minority business development

- Support existing businesses



Workforce Housing development

- Promoting affordable housing for households that earn enough to support themselves, but not enough in areas near their workplace.

